



**PARKING AREA SETTING OUT TABLE & LEVELS**

POINT	CO-ORDINATES		
	Y	X	Z
A1	50889.121	3778157.724	5.863
A2	50885.382	3778156.735	5.815
A3	50884.690	3778156.088	5.799
A4	50884.776	3778155.361	5.790
A5	50892.516	3778142.117	5.850
A6	50889.716	3778140.468	5.770
A7	50896.669	3778135.520	5.792
A8	50893.933	3778133.307	5.627
A9	50896.398	3778130.666	5.736
A10	50900.398	3778134.010	5.934
A11	50902.216	3778134.708	6.078
A12	50904.428	3778136.116	6.328
A13	50903.216	3778131.845	5.998
A14	50893.140	3778125.924	5.575
A15	50889.818	3778124.025	5.380
A16	50886.496	3778122.126	5.185
A17	50886.432	3778125.578	5.172
A18	50889.335	3778127.263	5.322
A19	50890.754	3778127.985	5.383
A20	50891.707	3778129.711	5.456
A21	50891.369	3778131.258	5.472
A22	50886.916	3778138.819	5.690
A23	50883.319	3778141.564	5.621
A24	50878.828	3778141.017	5.552
A25	50878.301	3778140.718	5.539
A26	50880.775	3778136.372	5.589
A27	50871.780	3778131.252	5.365
A28	50869.306	3778135.598	5.315
A29	50868.504	3778136.260	5.305
A30	50865.320	3778132.405	5.405
A31	50843.578	3778150.365	5.126
A32	50846.763	3778154.220	5.026
A33	50846.401	3778155.528	4.977
A34	50841.582	3778154.195	5.077
A35	50834.733	3778178.966	4.974
A36	50839.552	3778180.298	4.874
A37	50838.589	3778184.908	4.854
A38	50865.046	3778192.224	6.201
A39	50866.299	3778187.694	6.220
A40	50869.235	3778188.506	6.311
A41	50868.434	3778191.403	6.430
A42	50871.101	3778181.759	6.181
A43	50869.944	3778181.439	6.175
A44	50871.277	3778176.620	6.140
A45	50849.590	3778170.624	5.350
A46	50848.258	3778175.443	5.210
A47	50847.101	3778175.323	5.160
A48	50850.086	3778164.328	5.110
A49	50851.243	3778164.648	5.120
A50	50849.910	3778169.467	5.300
A51	50871.597	3778175.463	6.040
A52	50872.929	3778170.644	5.930
A53	50874.086	3778170.964	5.965
A54	50875.951	3778164.217	5.834
A55	50874.795	3778163.897	5.828
A56	50876.127	3778159.078	5.735
A57	50856.850	3778153.748	5.160
A58	50855.518	3778158.567	5.260
A59	50851.990	3778157.592	5.110
A60	50862.529	3778148.886	5.280
A61	50863.322	3778149.105	5.295
A62	50861.989	3778153.924	5.345
A63	50876.447	3778157.921	5.630
A64	50877.779	3778153.102	5.540
A65	50878.994	3778150.388	5.550
A66	50883.855	3778147.687	5.716
A67	50884.555	3778148.640	5.716
A68	50880.611	3778151.249	5.580
A69	50878.496	3778155.012	5.640

**CHANNEL SETTING OUT TABLE & LEVELS**

POINT	CO-ORDINATES		
	Y	X	Z
B1	50838.962	3778185.323	5.519
B2	50827.218	3778230.686	4.477
B3	50815.949	3778230.563	3.685

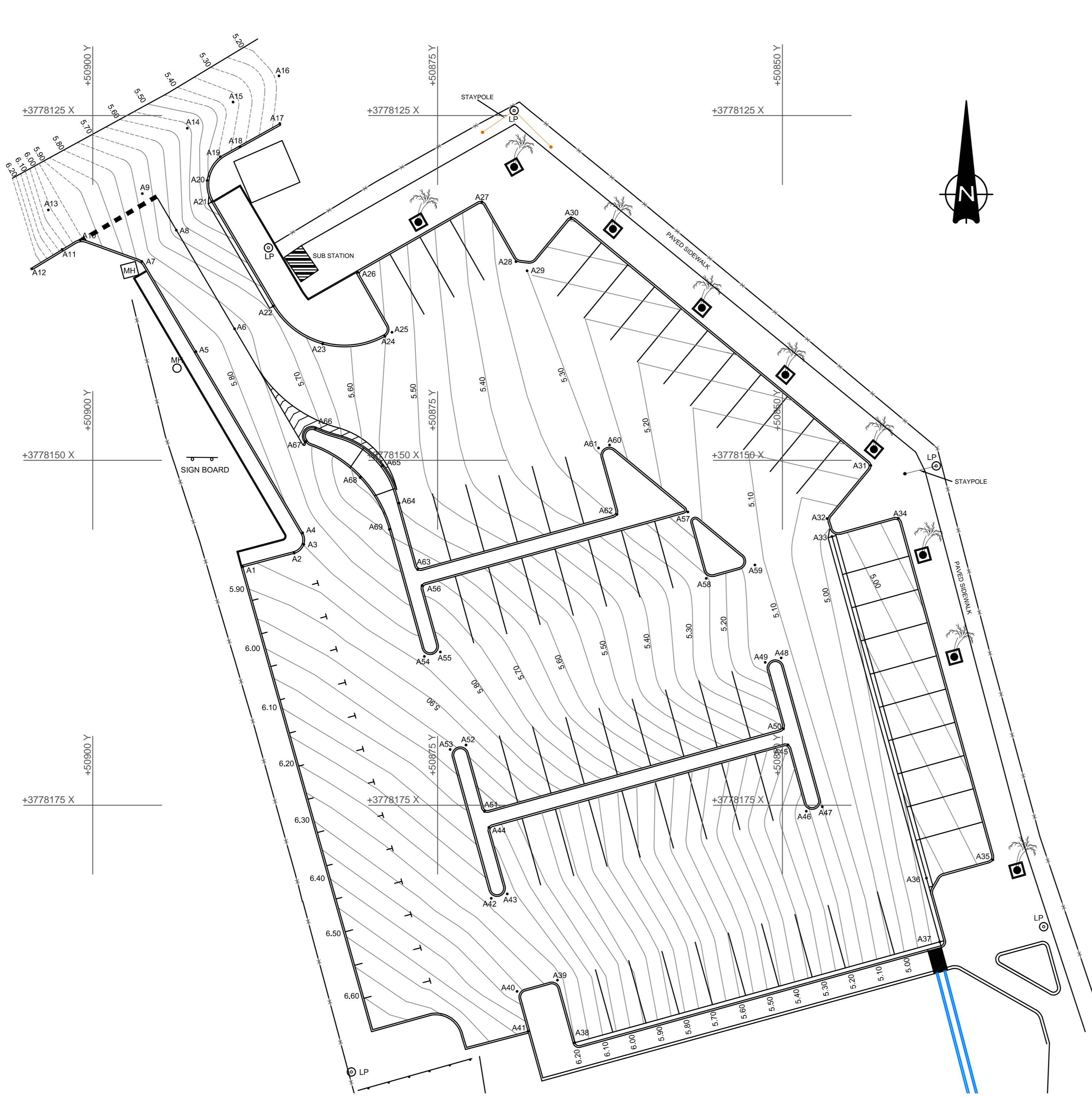

**PARKING AREA SETTING OUT & LEVELS LAYOUT**  
SCALE 1:200  
CONTOUR INTERVAL = 50mm

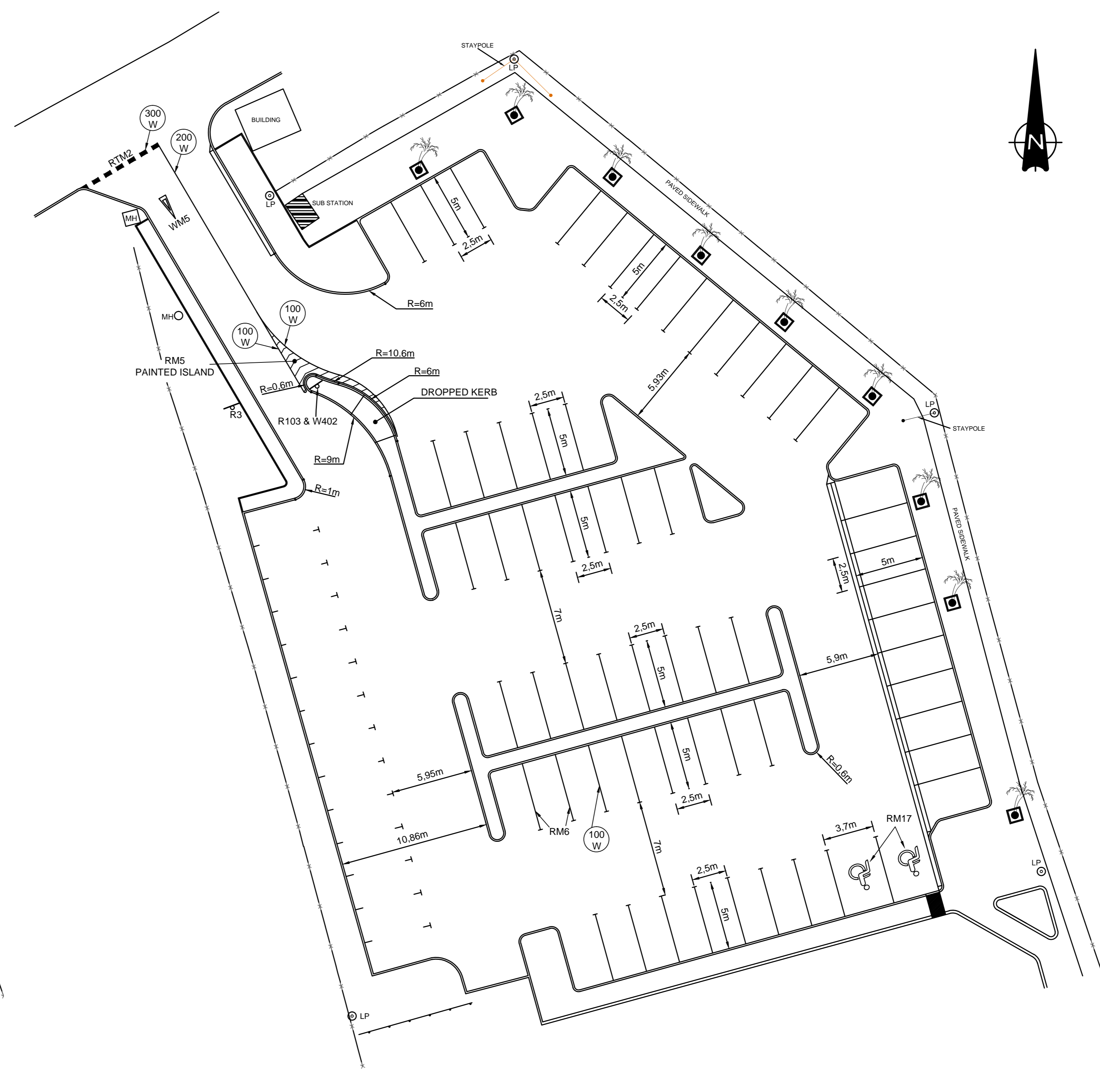

**PARKING AREA DIMENSIONS & ROAD MARKINGS**  
SCALE 1:200

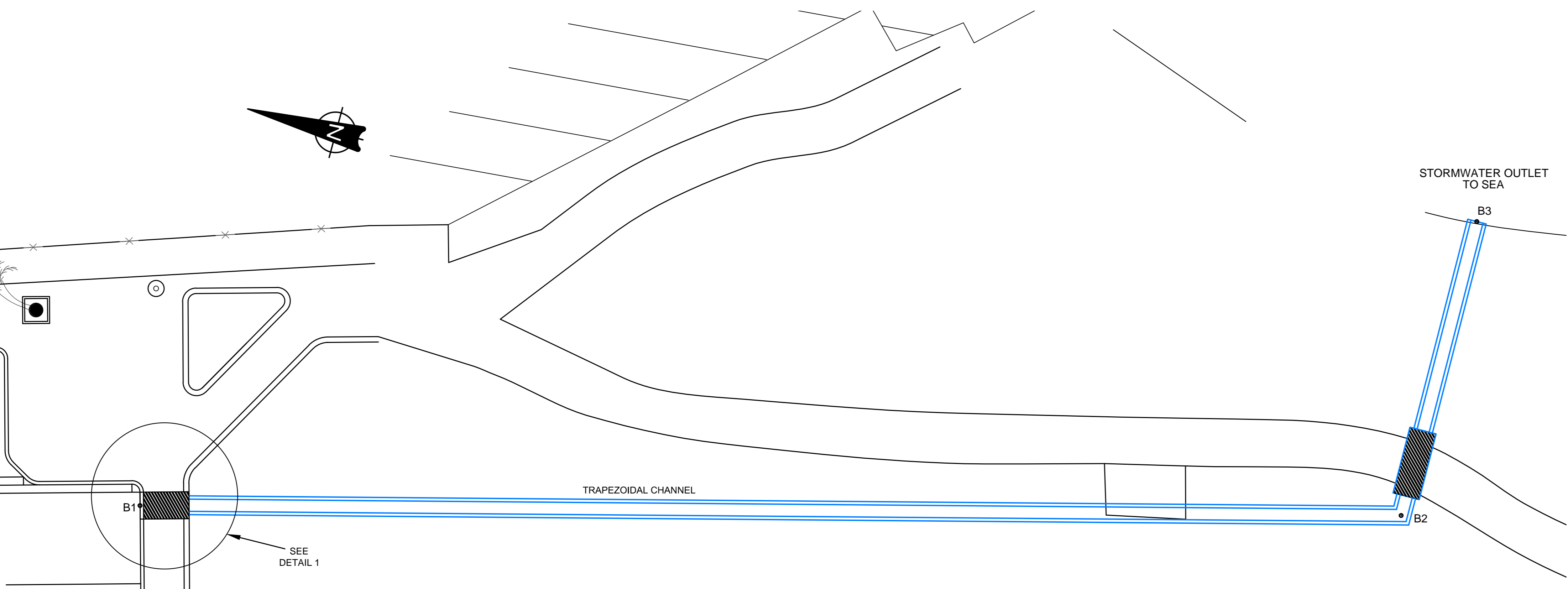

**PLAN VIEW OF TRAPEZOIDAL CHANNEL**  
SCALE 1:100

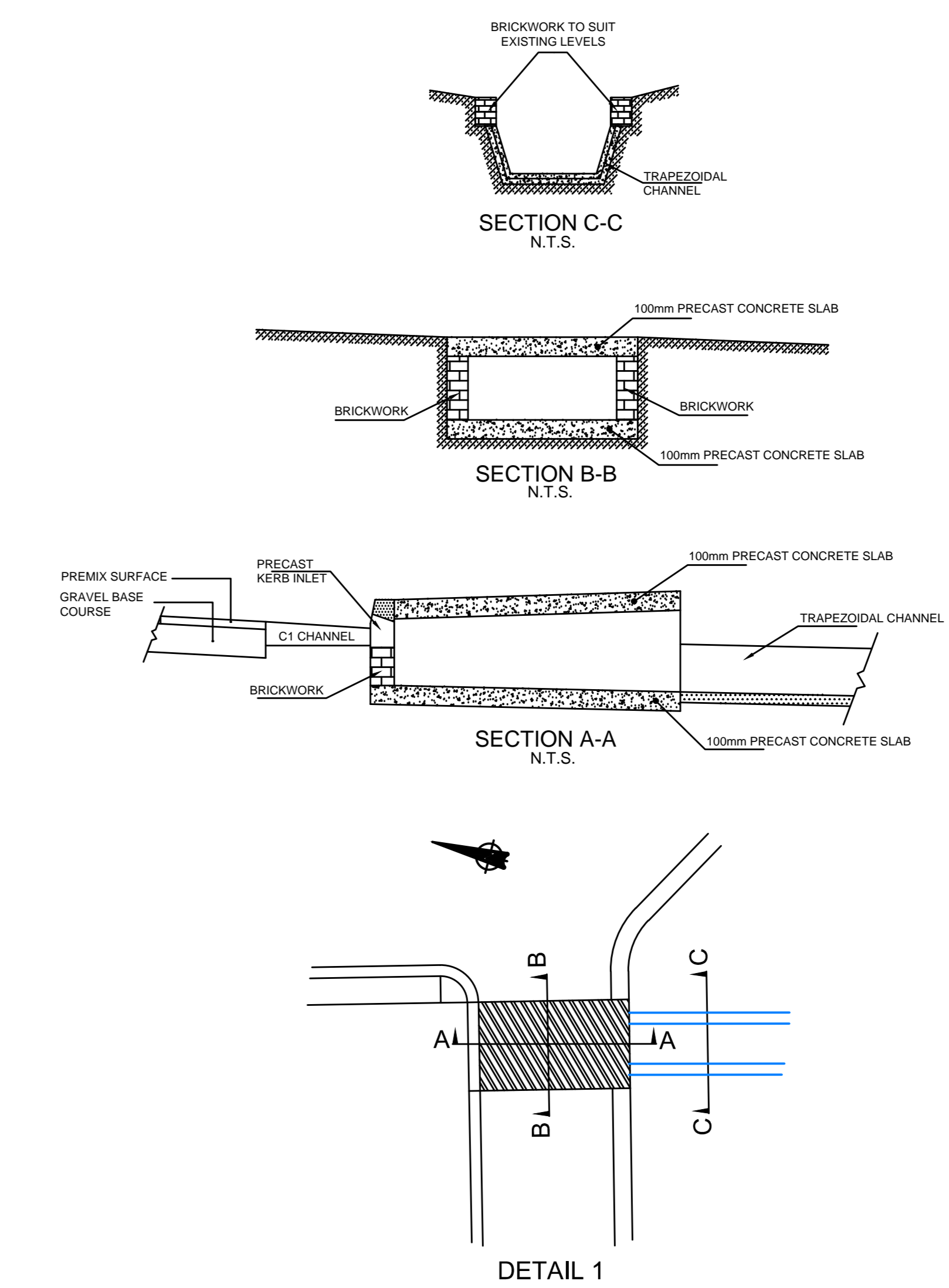

**TYPICAL KERB INLET & CHANNEL DETAIL**  
N.T.S.

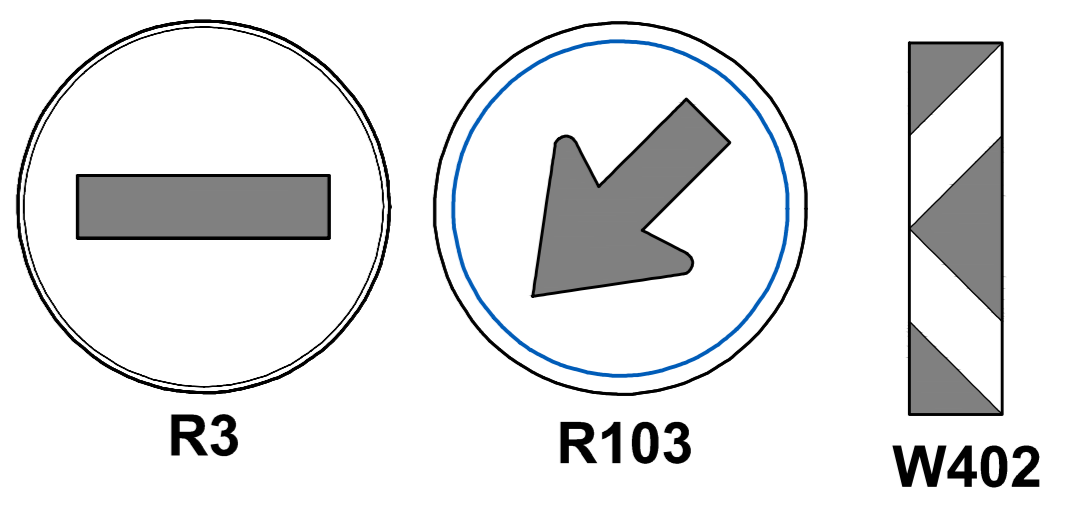

**NOTES**

- ALL LEVELS GIVEN AT POSITION INDICATED ON KERB DETAILS
- EXISTING BASE AND SURFACE MATERIAL TO BE RIPPED AND STOCKPILED FOR POSSIBLE FUTURE USE. SUBGRADE TO BE RIPPED AND RECOMPACTED TO 100% MOD ASSHTO
- ROAD MARKING TO BE IN ACCORDANCE WITH THE LATEST EDITION OF THE SOUTH AFRICAN ROAD TRAFFIC SIGNS MANUAL
- THE POSITIONS OF ALL THE EXISTING SERVICES MUST BE ESTABLISHED PRIOR TO ANY CONSTRUCTION WORKS
- LOCATION OF EXISTING SERVICES CAN BE FOUND ON DRAWING NR. R0-5789 SHEETS 1 OF 3
- TAKE NOTE: POSITION OF SERVICES INDICATED ON PLAN IS NOT EXACT. PRECISE LOCATION OF SERVICES MUST BE OBTAINED FROM WAYLEAVES
- ALL WAYLEAVES MUST BE IN PLACE BEFORE ANY CONSTRUCTION WORK COMMENCE

SERVICE	EXISTING	SIGN	PROPOSED
SEWER	N/A		N/A
STORMWATER	N/A		N/A
WATERMAIN	N/A		N/A
ELECTRICITY	N/A		N/A
TELKOM	N/A		N/A
GAS	N/A		N/A
D.P. & F.	N/A		N/A

**4L36**  
9.140m MSL  
Y=50919.80 X=3778178.13 Z=0.140m  
MAIN RD, KALK BAY

**DETAIL FOR LAYING DISH CHANNEL (V-CHANNEL)**

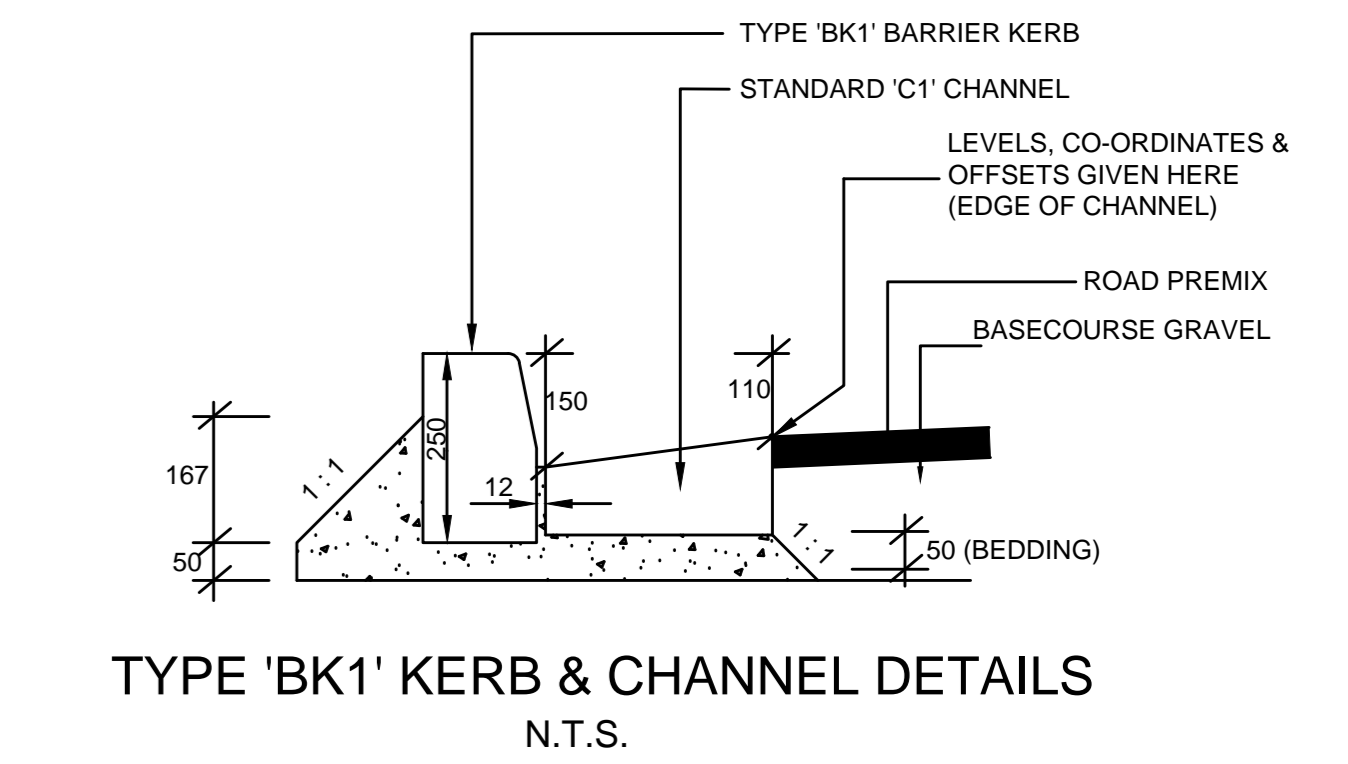
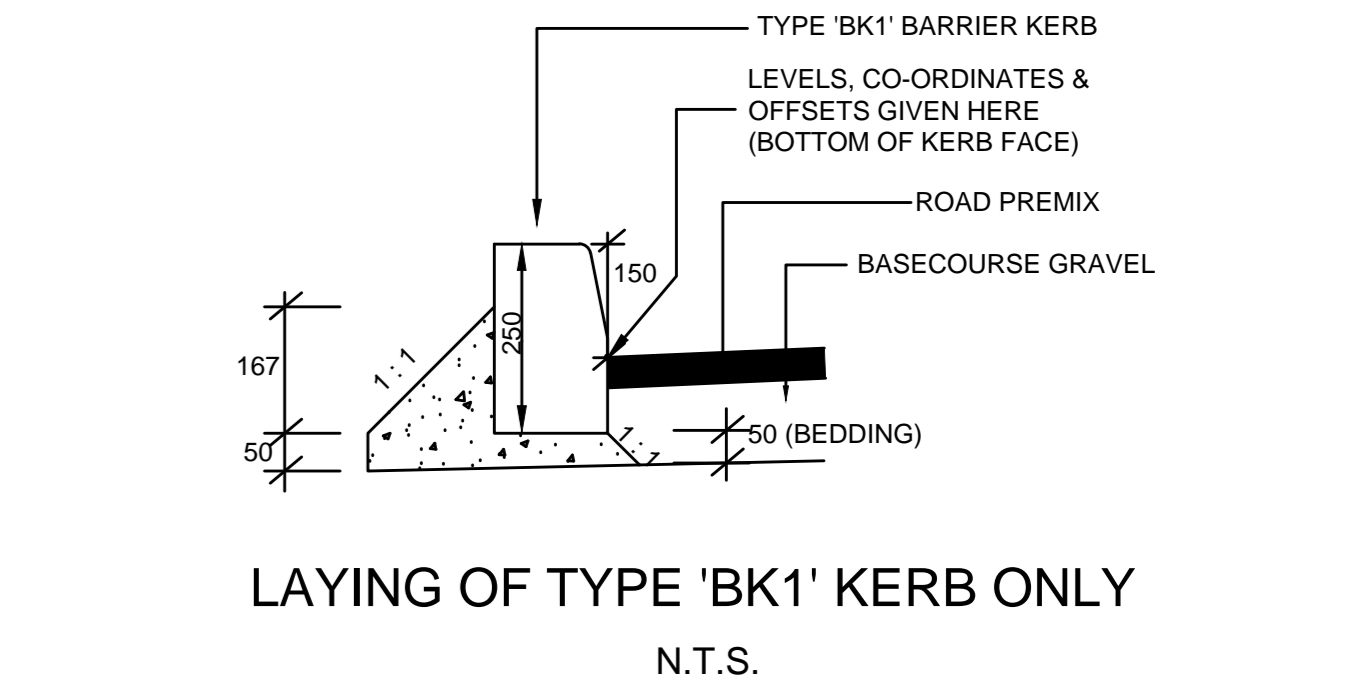
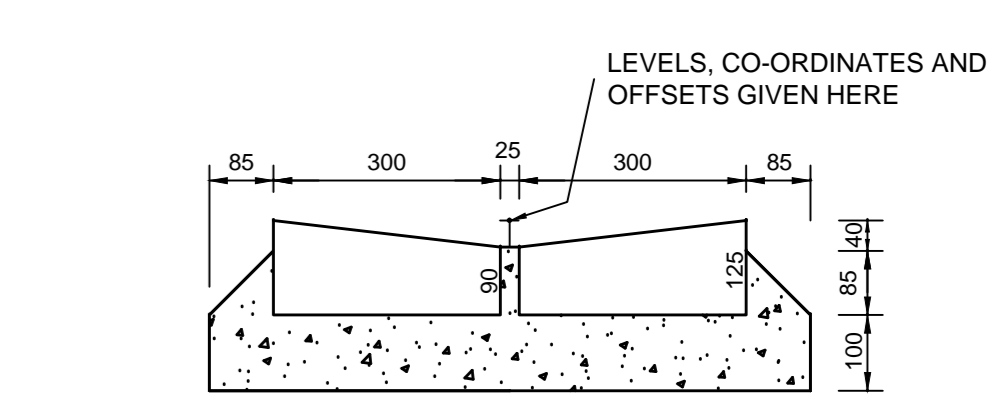

**LIST OF SHEETS**

SHEET 1 OF 3: PROPOSED PLAN LAYOUT & SERVICES
SHEET 2 OF 3: PROPOSED SETTING OUT, STORMWATER & ROAD MARKINGS LAYOUT
SHEET 3 OF 3: PROPOSED SECTIONS DETAILS

NO	DATE	DESCRIPTION	EXAM	APP

SURVEYED	J. COETZEE	OCTOBER 2010
DESIGNED	D. DU TOIT	SEPTEMBER 2013
DRAWN		
CAD	D. DU TOIT	SEPTEMBER 2013
EXAMINED		
APPROVED		
CORR FILE CORR FILE	EST. No	

<b>M. WHITEHEAD</b> COMMISSIONER TRANSPORT FOR CAPE TOWN	<b>P. BOOTH</b> HEAD, ROADS & STORMWATER DESIGN
<b>D. HUGO</b> DIRECTOR, INFRASTRUCTURE	

**CITY OF CAPE TOWN**

**KALK BAY HARBOUR  
UPGRADING OF EXISTING PARKING AREA,  
THE POINT**

**PROPOSED SETTING OUT,  
STORMWATER  
&  
ROAD MARKINGS**

SCALE	DRAWING NO.
AS SHOWN	R0- 5789
ORIGINAL DRAWING	SHEET NO 2 OF 3
CAD FILE N°	REVISIONS
L:\ROADS\PROJECTS\SMNRoads	

4L36

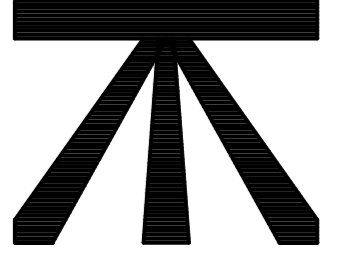

9.140m MSL

Y=50919.80 X=3778176.13 Z=9.140m  
MAIN RD, KALK BAY

SERVICE	EXISTING	SIGN	PROPOSED
SEWER	N/A		N/A
STORMWATER	N/A		N/A
WATERMAIN	N/A		N/A
ELECTRICITY	N/A		N/A
TELKOM	N/A		N/A
GAS	N/A		N/A
D.P. & F.	N/A		N/A

**NOTES**

1. ALL LEVELS GIVEN AT POSITION INDICATED ON KERB DETAILS
2. EXISTING BASE AND SURFACE MATERIAL TO BE RIPPED AND STOCKPILED FOR POSSIBLE FUTURE USE. SUBGRADE TO BE RIPPED AND RECOMPACTED TO 100% MOD ASSHTO
3. LOCATION OF EXISTING SERVICES CAN BE FOUND ON DRAWING NR. R0-5789 SHEETS 1 OF 3
4. THE POSITIONS OF ALL THE EXISTING SERVICES MUST BE ESTABLISHED PRIOR TO ANY CONSTRUCTION WORKS
5. TAKE NOTE: POSITION OF SERVICES INDICATED ON PLAN IS NOT EXACT. PRECISE LOCATION OF SERVICES MUST BE OBTAINED FROM WAYLEAVES
6. ALL WAYLEAVES MUST BE IN PLACE BEFORE ANY CONSTRUCTION WORK COMMENCE
7. ALL LEVELS AND ROAD MARKINGS CAN BE FOUND ON DRAWING NR. R0-5789 SHEET 2 OF 3

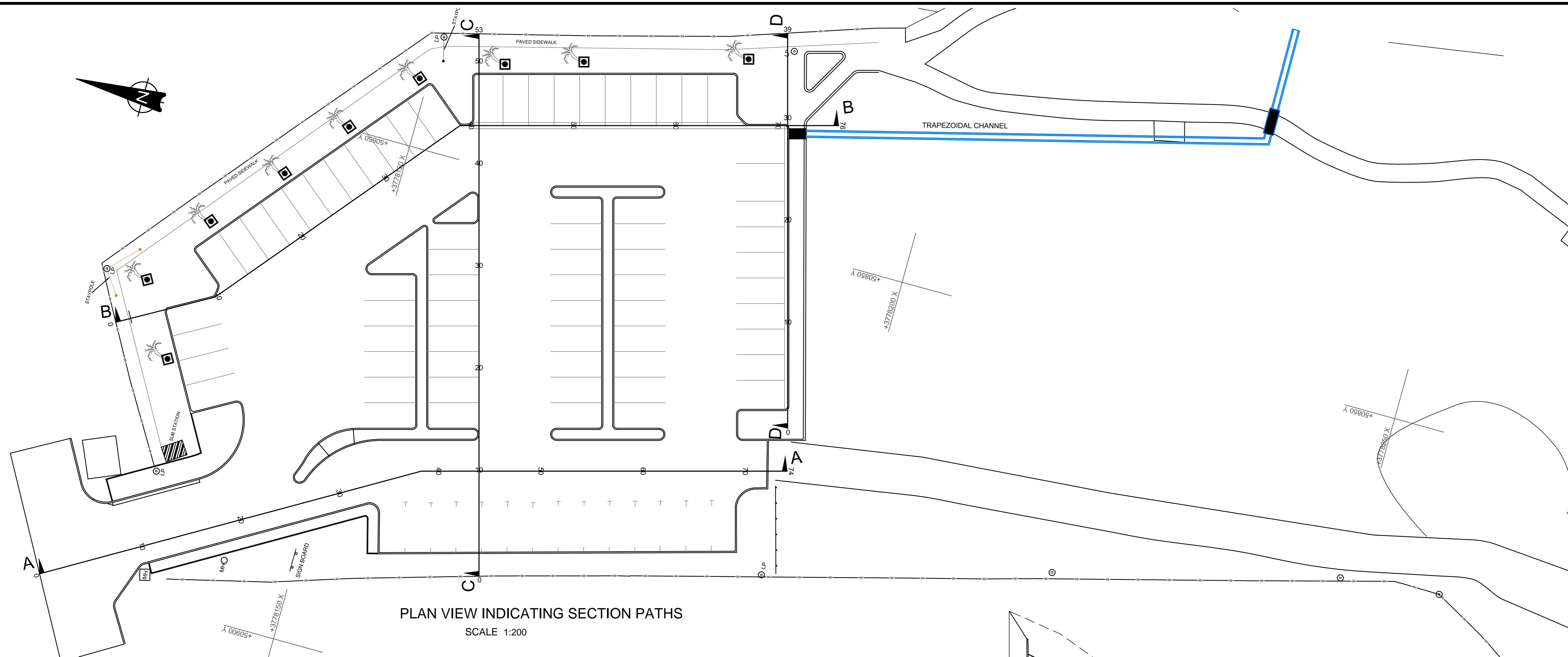

PLAN VIEW INDICATING SECTION PATHS  
SCALE 1:200

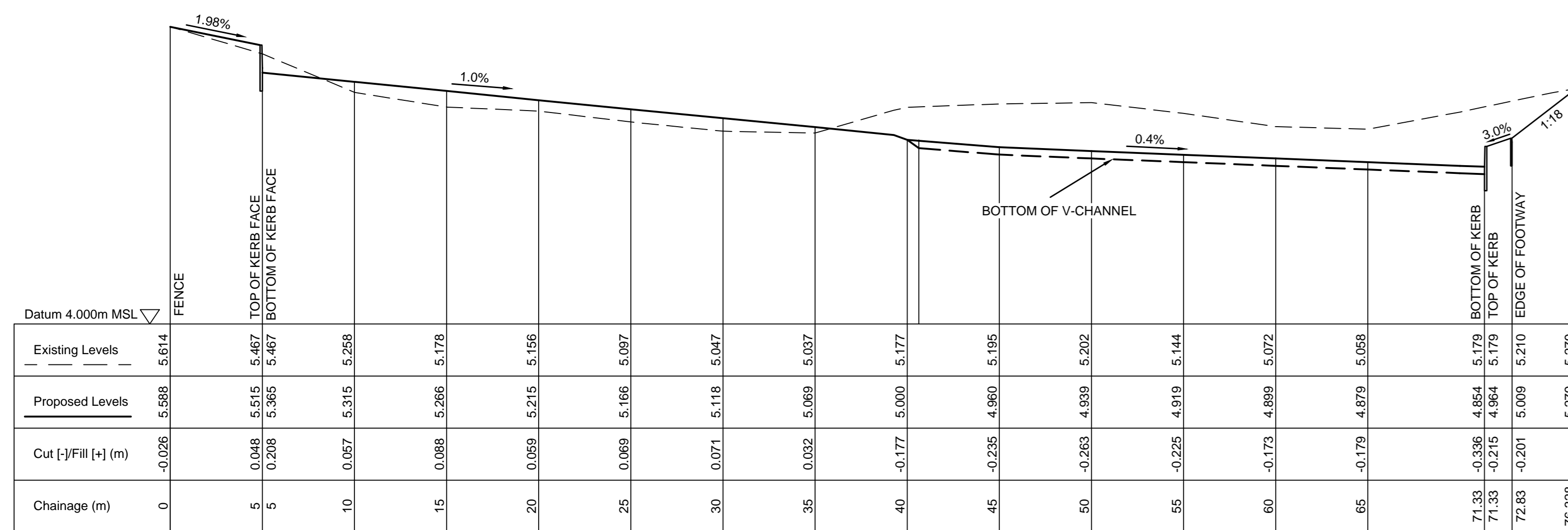

LONGITUDINAL SECTION THROUGH B-B  
SCALES - HORIZONTAL 1:200  
VERTICAL 1:20

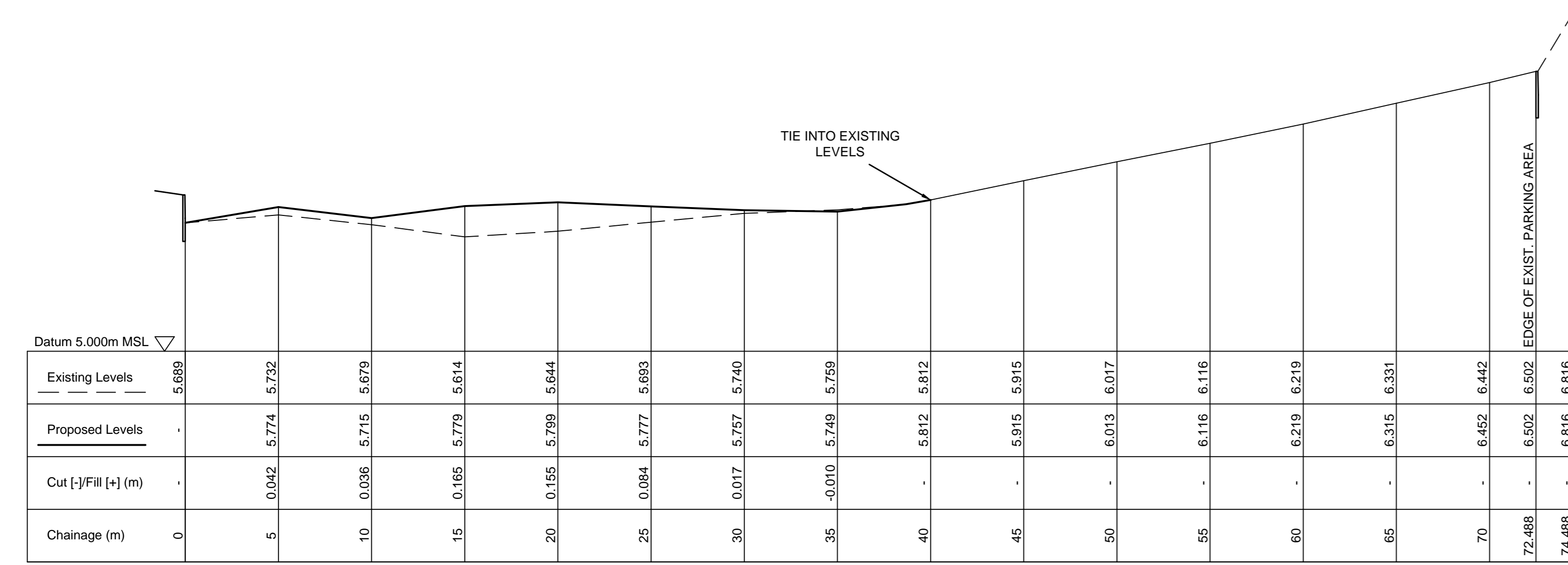

LONGITUDINAL SECTION THROUGH A-A  
SCALES - HORIZONTAL 1:200  
VERTICAL 1:20

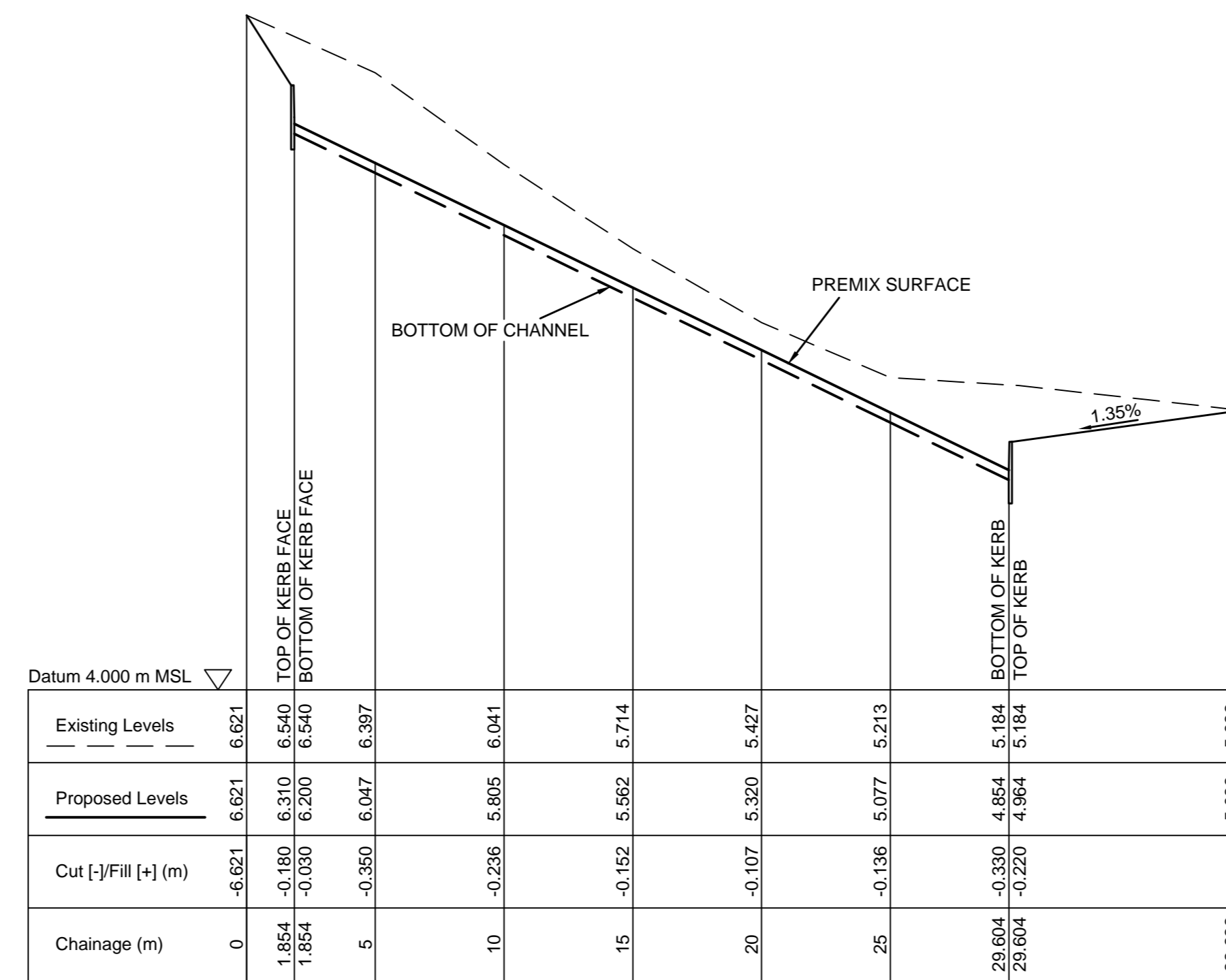

LONGITUDINAL SECTION THROUGH D-D  
SCALES - HORIZONTAL 1:200  
VERTICAL 1:20

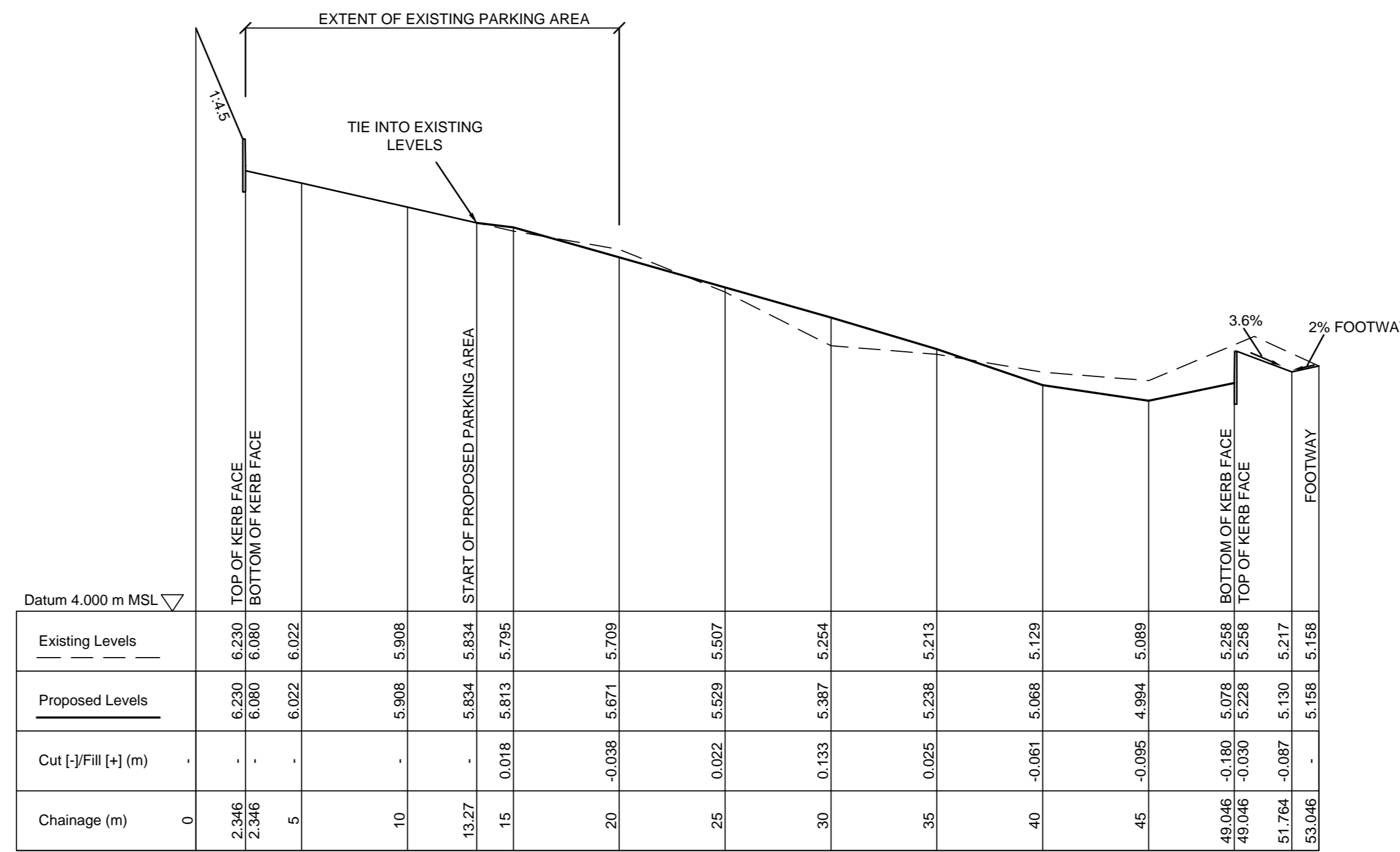

LONGITUDINAL SECTION THROUGH C-C  
SCALES - HORIZONTAL 1:200  
VERTICAL 1:20

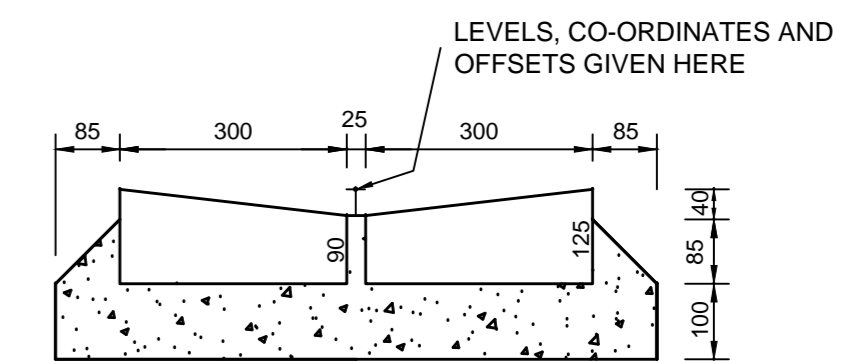

DETAIL FOR LAYING DISH CHANNEL (V-CHANNEL)  
N.T.S.

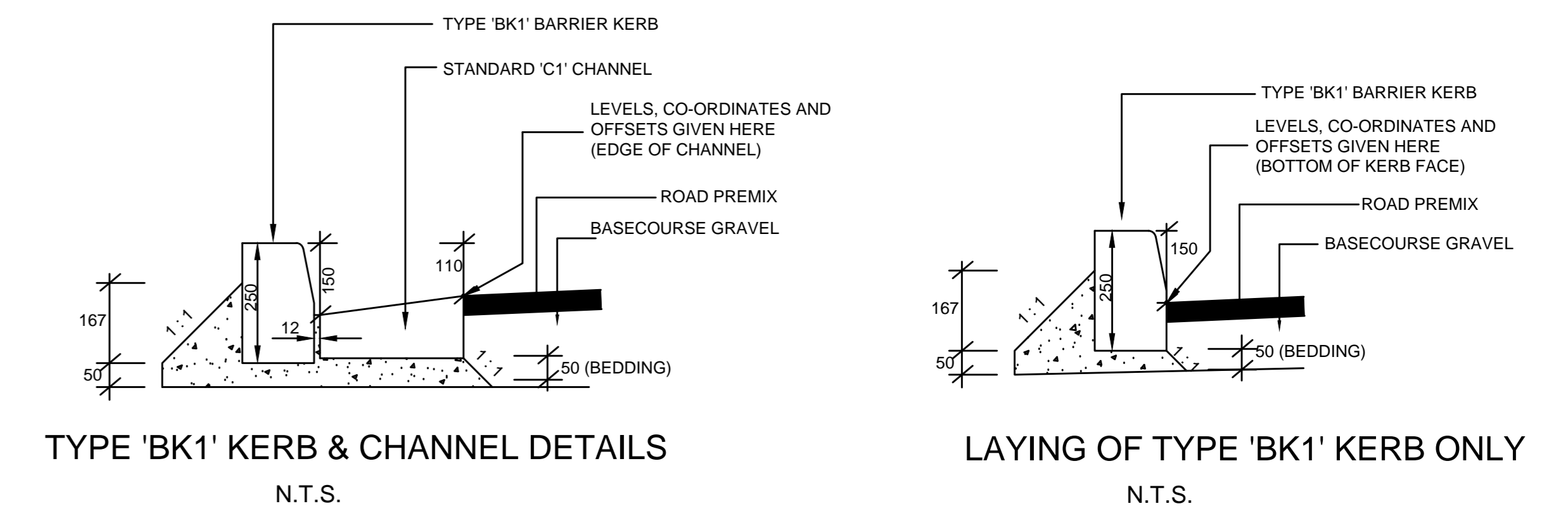

TYPE 'BK1' KERB & CHANNEL DETAILS  
N.T.S.

LAYING OF TYPE 'BK1' KERB ONLY  
N.T.S.

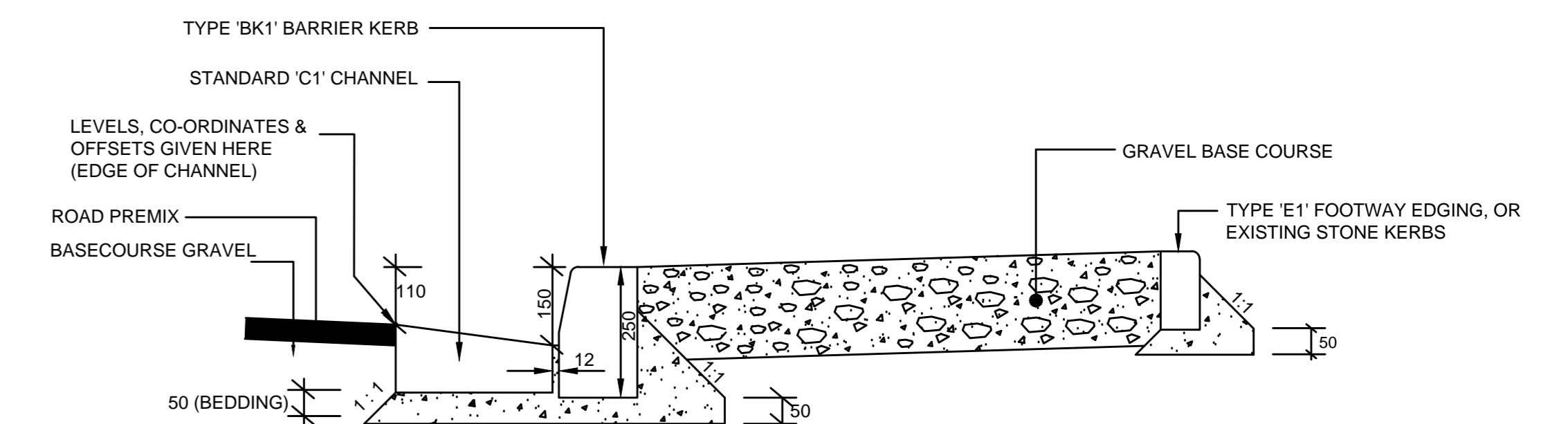

TYPICAL FOOTWAY DETAILS ALONG SECTION D-D  
N.T.S.

**LIST OF SHEETS**

- SHEET 1 OF 3: PROPOSED PLAN LAYOUT & SERVICES
- SHEET 2 OF 3: PROPOSED SETTING OUT, STORMWATER & ROAD MARKINGS LAYOUT
- SHEET 3 OF 3: PROPOSED SECTIONS DETAILS

NO.	DATE	DESCRIPTION	EXAM	APP	SURVEYED	J. COETZEE	OCTOBER 2010	M. WHITEHEAD	COMMISSIONER	TRANSPORT FOR CAPE TOWN	P. BOOTH	HEAD:	CITY OF CAPE TOWN	KALK BAY HARBOUR	UPGRADING OF EXISTING PARKING AREA, THE POINT	PROPOSED PARKING AREA SECTIONS	SCALE	DRAWING NO.
					DESIGNED	D. DU TOIT	SEPTEMBER 2013										AS SHOWN	R0- 5789
					CAD	D. DU TOIT	SEPTEMBER 2013										ORIGINAL DRAWING	SHEET NO 3 OF 3
					EXAMINED												CAD FILE N°	REVISIONS
					CORR FILE												L:\ROADS\PROJECTS\MINROADS	